



ASH VAC

OPERATING INSTRUCTIONS



Thermal over load protected motor

MODEL LSAV 1000

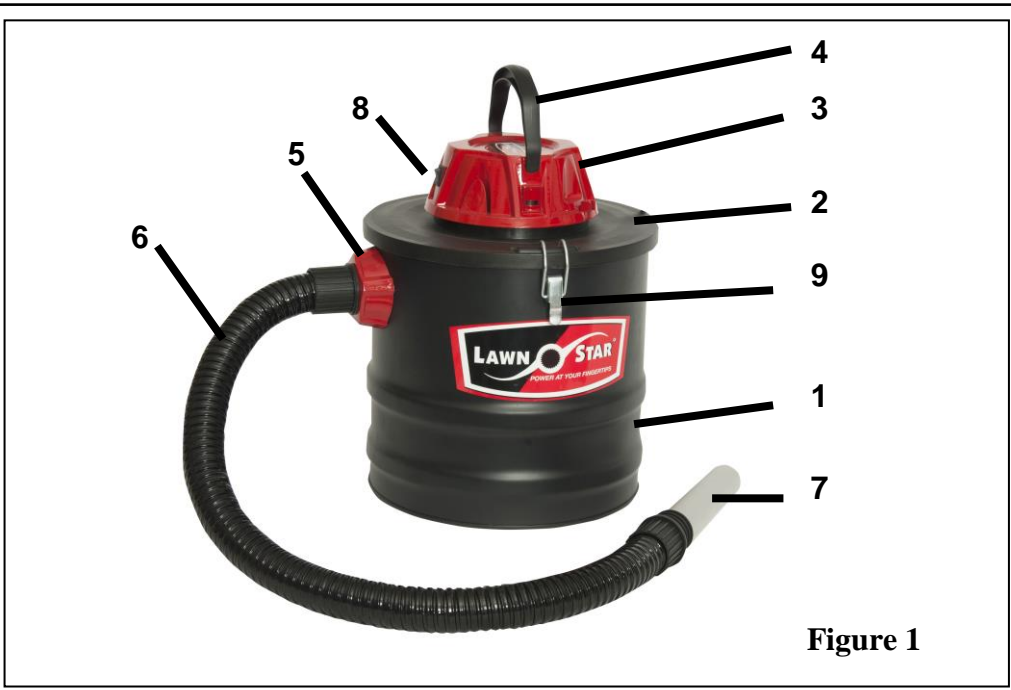

Figure 1

DESCRIPTION OF PARTS

- 1. Ash drum
- 2. Lid
- 3. Power head
- 4. Handle
- 5. Inlet coupling
- 6. Fire resistant suction hose
- 7. Suction nozzle
- 8. ON/OFF Power switch
- 9. Lid securing latches

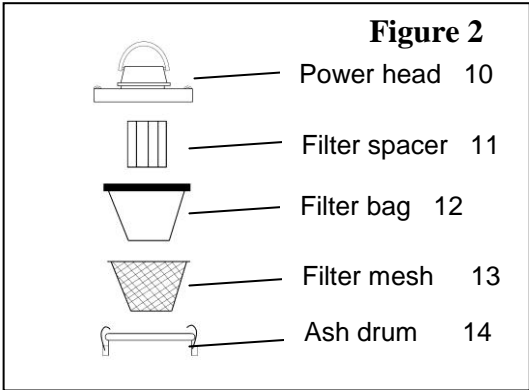





Figure 2

SYMBOL	DESCRIPTION
	<p>ATTENTION! OBSERVE THE FOLLOWING SAFETY WARNINGS</p>
	<p>READ THE OPERATORS MANUAL BEFORE OPERATING THIS MACHINE. IT CONTAINS SAFETY AND OPERATING INSTRUCTIONS. KEEP IT IN A SAFE PLACE FOR FUTURE REFERENCE.</p>
	<p>WARNING! SWITCH THE VACUUM OFF AND DISCONNECT FROM THE MAINS SUPPLY BEFORE MAKING ADJUSTMENTS, CLEANING BLOCKAGES, OR STARTING ANY CLEANING AND MAINTENANCE PROCEDURES.</p>

Thank you for purchasing the Lawn Star ash vac which is one of the finest and most advanced ash vacs today's technology can produce. Before you begin using it, please read this instruction manual carefully and familiarise yourself with the control and the proper use of this product to ensure you get the best possible performance from it.

SAFETY PRECAUTIONS

Inspect your ash vac and its supply/extension cable before each operation. If any part is damaged or worn, repair or replace before operation. Do not operate with damaged or tangled supply/extension cable. If the supply cord is damaged, it must be replaced by a special cord available from Lawn Star (Pty)Ltd or its service agent.

Use only genuine Lawn Star (Pty)Ltd. replacement parts when servicing or repairing the unit. These parts are available from your supplying dealer or service agent.

Always switch off the ash vac and wait for it to stop before opening drum or putting the nozzle down. Disconnect the unit from the power supply when unattended or not in use, before servicing, cleaning or when emptying the drum.

This product is intended for household use only.

Attention: This product is for dry pick-up use only.

The ash vac is specially designed to vacuum ash and other debris left behind after making a fire from the fire place.

Wait at least 24 hours before vacuuming an oven or a fireplace in order to be sure that the fire has gone out and the ash has cooled down.

Check the suction hose and ash drum regularly when extracting, to assess levels of heating.

If the appliance heats up, switch it off, pull the mains plug out and remove the filter bag immediately.

Always empty ash vac container and clean filter after each use.

Do not store unit with ash inside this could be a fire hazard.

Do not vacuum water, oil, chemicals or any other wet substance.

Do not immerse the appliance in water.

Keep free of dust, lint, hair etc.

Do not carry, pull or hang the ash vac by the cable.

Do not operate the unit without the filter bag in place.

Do not operate the unit if the filter bag is damaged.

Disconnect from power supply before servicing or cleaning

Do not allow children under 16, nor anyone who is not familiar with these instructions to use the ash vac.

The ash vacuum is fitted with a thermal overload protector on the motor. If the filter bag(**Figure 2-12**)gets blocked the motor will over-heat and cut out. Allow the vacuum to cool, clean the filter (**Figure 2-12**) and continue as normal.

PREPARATIONS FOR USE

1. Unpack all components from packaging.(Figure 1)
2. Unclip latches and removed power head.(Figure 1)
3. Remove suction nozzle and suction hose from ash drum.
4. Fit filter mesh onto filter bag and secure by clipping mesh into filter seal (Figure 3-1).
5. Place this assembly onto ash drum ensuring that drum is inserted into the seal (Figure 3-2).
6. Place filter spacer onto top of filter bag (Figure 3-3).
7. Place lid onto ash drum ensuring that filter seal remains in place (Figure 3-4).
8. Fasten lid securing clamps to secure lid.
9. Insert the suction nozzle into one end of the suction hose by pressing firmly into place(Figure 3-5).
10. Insert the other end of vacuum hose into inlet coupling and rotate clock-wise to secure(Figure 3-6).
11. Insert plug into wall socket or extension lead.
12. Toggle on/off switch to the on position to switch on.

Figure 3

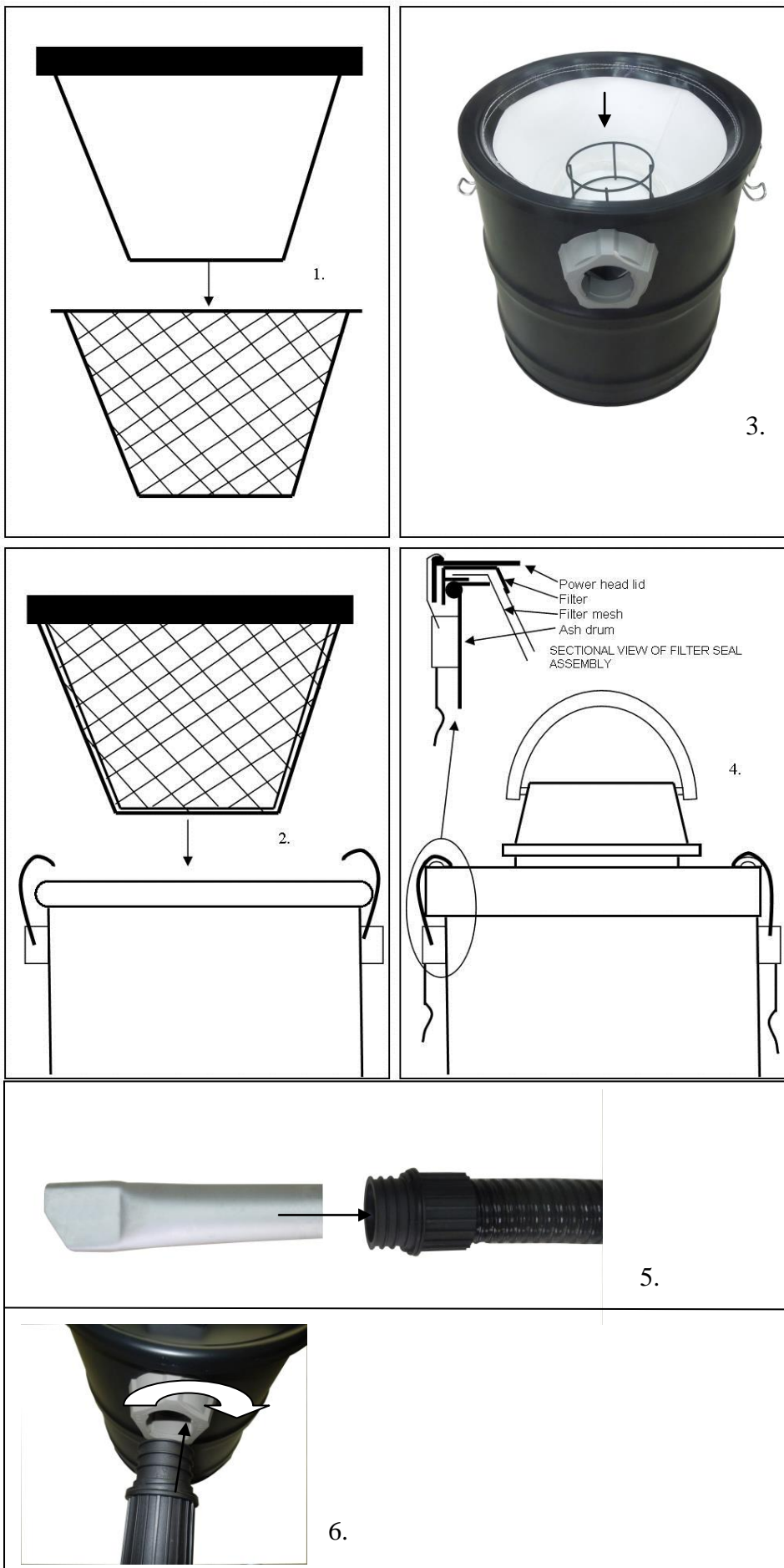

CAUTION

Before switching the ash vac on, ensure that the filter spacer (Figure 2-11), fire resistant filter bag (Figure 2-12) and filter mesh (Figure 2-13) are correctly attached to ash drum (Figure 2-14).

Ensure that the lid securing clips are secured and seals are correctly seated.

OPERATING INSTRUCTIONS

1. Insert plug into wall socket or extension lead.
2. Toggle on/off switch to the on position to switch on.
3. Use suction nozzle to vacuum ash from fire place.
4. Toggle on/off switch to off position.
5. Switch off and remove plug from wall socket.
6. Empty ash drum.
7. Clean filter bag.

Note: The ash vacuum is fitted with a thermal overload protector on the motor. If the filter bag (**Figure 2-12**) gets blocked the motor will over-heat and cut out. Allow the vacuum to cool, clean the filter (**Figure 2-12**) and continue as normal.

MAINTENANCE, CARE AND STORAGE

WARNING: ALWAYS DISCONNECT THE PLUG FROM THE POWER OUTLET BEFORE REMOVING THE POWER HEAD FROM ASH DRUM.

REMOVING AND CLEANING THE FILTER BAG

1. Verify that the power cord is disconnected from the power outlet
2. Remove power head and place in upside down position.
3. Remove filter spacer
4. Remove filter bag assembly from ash drum
5. Unclip filter mesh from filter bag
6. Clean filter bag by gently tapping it and brushing it off with a soft brush

REFITTING THE FILTER BAG

1. Fit filter mesh onto filter bag and secure by fitting mesh into filter seal (Figure 3-1).
2. Place this assembly onto ash drum ensuring that drum is inserted into the seal (Figure 3-2).
3. Place filter spacer onto top of filter (Figure 3-3).
4. Place lid onto ash drum ensuring that filter seal remains in place (Figure 3-4).
5. Fasten lid securing clamps to secure lid.

TROUBLE SHOOTING GUIDE

PROBLEM	PROBABLE CAUSE	CORRECTIVE ACTION
Vacuum won't suck	Filter bag blocked	Clean filter bag
	Suction nozzle blocked	Remove suction nozzle and clear blockage
	Suction hose blocked	Remove suction hose and clear blockage
	Ash drum full	Empty drum and clean filter bag
	Inlet coupling blocked	Remove suction hose and clear blockage
Vacuum won't switch on	Wall socket off	Switch on
	Extension cord damaged	Replace extension cord
	Circuit breaker tripped	Check and reset
	Motor overheated	Allow to cool and re-start
	Inlet coupling blocked	Remove suction hose and clear blockage
	Ash vacuum supply cord damaged	Send to service agent for repair
	Ash vacuum has over heated	Allow to cool and clean filter bag. Over load protector will reset when the motor has cooled. This could take 5-20 minutes

LAWN STAR (PTY) LTD.

For service and warranty repairs please contact your nearest Service Agent listed below:

CUSTOMER CARE : 0860-LAWNSTAR

HEAD OFFICE : 98 Bofors Circle, Epping 2 South, Cape Town
PO Box 496, Parow, 7499

Tel: 021-535-5249

Fax: 021-535-4624

EASTERN CAPE: Tel: 041-366-1300

Fax: 041-366-1300

FREE STATE : Tel: 082-556-6325

Fax: 086-691-6297

GAUTENG : Tel: 011-979-0162

Fax: 011-979-0174

KZN : Tel: 031-579-4390

Fax: 031-579-4400

WEST COAST : 082-460-3507

NORTHERN CAPE: 082-460-3507

OVERBERG : 084-609-7341

NAMIBIA : Tel: 061- 232-475

Fax: 061- 242-139

BOTSWANA : +267-318-6851

ZIMBABWE : +263-4-486 192/646

For more information visit: www.lawnstar.co.za

LAWN STAR (PTY) LTD.

WARRANTY CARD

LSAV 1000

Please read carefully

This card is required for warranty repair claims. Please fill in this card and keep it in a safe place, stapled to the original proof of purchase. The original proof of purchase (i.e. receipt, invoice, docket, etc.) must show the original date of purchase and clearly identify the product.

WITHOUT THIS CARD AND ORIGINAL PROOF OF PURCHASE, ANY WARRANTY BECOMES NULL AND VOID.

Make : Serial No: Date of Purchase:
Model :

PURCHASER
NAME:
ADDRESS:
PHONE :

PURCHASED FROM
NAME :
ADDRESS:
PHONE:

LIMITED DOMESTIC USE WARRANTY

Lawn Star (Pty) Ltd. guarantees this unit to be free from defects in material and workmanship. If any such defect should become apparent during a period of

12 MONTHS

from the date of the original purchase, we undertake to repair this unit free of charge or replace this unit with a factory reconditioned unit at our discretion. This does not prejudice your rights in terms of the Consumer Protection Act.

Transport costs to our service centre and back to the owner, should such costs occur, will be carried by the owner of the unit, not by us.

The repaired or replaced unit will be covered by this warranty for the remainder of the original warranty period.

This warranty covers only the original purchaser of this unit.

This warranty becomes invalid if :

- the unit has been used commercially or for rental purposes;
- damage has been caused by misuse, abuse, accident or normal wear and tear;
- spares and accessories other than specified by us are used with this unit;
- the unit has been opened, altered or otherwise tampered with;

The suction hose and filter are wearing parts and are not covered by Warranty.

PLEASE READ AND UNDERSTAND THE INSTRUCTION MANUAL BEFORE YOU OPERATE THIS UNIT.